

Die Weiterentwicklung unserer höchst erfolgreichen Schnellsteckverbinder-Serie im Material Messing vernickelt.

Die Vorteile der weiterentwickelten Baureihe sind:

- wesentlich einfacheres Stecken und Lösen des Schlauches, vielfach wiederholbar
- verwendbar auch bei nichtkalibrierten Schläuchen
- geeignet für den Vakuumbetrieb

| | |
|-----------------------|--|
| Arbeitsdruck: | -0,99 bis 16 bar |
| Betriebstemperatur: | -20 °C bis +80 °C |
| Material: | Messing vernickelt |
| Medium: | Druckluft |
| Dichtmaterial: | NBR |
| Lösering: | Hostaform / Messing vernickelt (für Schlauch-Außen-Ø 3 mm) |
| Spannung: | Edelstahl |
| O-Ring: | NBR |
| Empfohlener Schlauch: | PA, PU |
| Anwendungsbereich: | Druckluftanlagen, Vakuum |

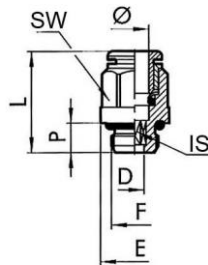

745.014-8

Gerade Steckverschraubungen, Außengewinde zylindrisch mit O-Ring und Außensechskant (M-Gewinde ohne Außensechskant)

| Typen Nr. | Artikel Nr. | Ø mm | F mm | SW mm | IS mm | P mm | L mm | D mm | E mm |
|------------|-------------|------|-------|-------|-------|------|------|------|------|
| 745.003-3 | 108547 | 3 | M3 | Ø 5,8 | 1,5 | 3,0 | 12,6 | 1,5 | 5,8 |
| 745.005-3 | 108548 | 3 | M5 | Ø 5,8 | 2 | 3,5 | 13,0 | 2,0 | 5,8 |
| 745.005-4 | 108549 | 4 | M5 | Ø 9 | 2,5 | 4,0 | 20,3 | 2,6 | 9,0 |
| 745.005-5 | 108550 | 5 | M5 | Ø 12 | 2,5 | 4,0 | 22,5 | 2,6 | 12,0 |
| 745.005-6 | 108551 | 6 | M5 | Ø 11 | 2,5 | 4,0 | 21,9 | 2,6 | 11,0 |
| 745.007-4 | 108552 | 4 | M7 | Ø 9 | 3 | 4,0 | 18,9 | 3,1 | 9,8 |
| 745.007-6 | 108553 | 6 | M7 | Ø 11 | 4 | 5,0 | 23,0 | 4,1 | 11,0 |
| 745.018-4 | 108554 | 4 | G 1/8 | 10 | 3 | 6,0 | 18,0 | 3,1 | 14,0 |
| 745.018-5 | 108555 | 5 | G 1/8 | 13 | 3 | 6,0 | 22,0 | 3,1 | 15,0 |
| 745.018-6 | 108556 | 6 | G 1/8 | 12 | 4 | 6,0 | 21,6 | 4,1 | 14,0 |
| 745.018-8 | 108557 | 8 | G 1/8 | 13 | 5 | 6,0 | 25,4 | 5,2 | 14,0 |
| 745.014-4 | 108558 | 4 | G 1/4 | 10 | 3 | 8,0 | 19,8 | 3,1 | 18,0 |
| 745.014-5 | 108559 | 5 | G 1/4 | 12 | 3 | 8,0 | 24,0 | 3,1 | 18,0 |
| 745.014-6 | 108560 | 6 | G 1/4 | 12 | 4 | 8,0 | 20,3 | 4,1 | 18,0 |
| 745.014-8 | 108561 | 8 | G 1/4 | 14 | 6 | 8,0 | 24,4 | 6,2 | 18,0 |
| 745.014-10 | 108562 | 10 | G 1/4 | 16 | 7 | 8,0 | 29,2 | 7,2 | 18,0 |
| 745.014-12 | 108563 | 12 | G 1/4 | 19 | 7 | 8,0 | 30,5 | 7,2 | 21,0 |
| 745.038-8 | 108564 | 8 | G 3/8 | 14 | 6 | 9,0 | 22,8 | 6,2 | 22,0 |
| 745.038-10 | 108565 | 10 | G 3/8 | 16 | 8 | 9,0 | 26,5 | 8,2 | 22,0 |
| 745.038-12 | 108566 | 12 | G 3/8 | 19 | 10 | 9,0 | 28,1 | 10,2 | 22,0 |
| 745.038-14 | 108567 | 14 | G 3/8 | 22 | 10 | 9,0 | 33,8 | 10,2 | 24,6 |
| 745.012-10 | 108568 | 10 | G 1/2 | 16 | 8 | 11,0 | 29,8 | 8,2 | 26,0 |
| 745.012-12 | 108569 | 12 | G 1/2 | 19 | 10 | 11,0 | 29,3 | 10,2 | 26,0 |
| 745.012-14 | 108570 | 14 | G 1/2 | 22 | 12 | 11,0 | 31,5 | 12,2 | 26,0 |

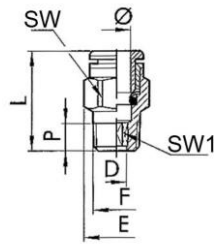

744.018-6

Gerade Steckverschraubungen, Außengewinde konisch mit /

| Typen Nr. | Artikel Nr. | Ø mm | F mm | SW mm | SW1 mm | D mm | E mm | L mm | P mm |
|------------|-------------|------|-------|-------|--------|------|------|------|------|
| 744.018-4 | 108584 | 4 | R 1/8 | 10 | 3 | 3,1 | 11,3 | 18,5 | 6,2 |
| 744.018-6 | 108585 | 6 | R 1/8 | 12 | 4 | 4,1 | 13,5 | 22,5 | 6,2 |
| 744.018-8 | 108586 | 8 | R 1/8 | 13 | 5 | 5,2 | 14,3 | 26,0 | 6,2 |
| 744.014-6 | 108587 | 6 | R 1/4 | 12 | 4 | 4,1 | 13,2 | 22,3 | 8,5 |
| 744.014-8 | 108588 | 8 | R 1/4 | 14 | 6 | 6,2 | 15,8 | 25,5 | 8,5 |
| 744.014-10 | 108589 | 10 | R 1/4 | 16 | 7 | 7,2 | 17,7 | 28,9 | 8,5 |
| 744.038-8 | 108590 | 8 | R 3/8 | 14 | 6 | 6,2 | 16,6 | 24,9 | 9,0 |
| 744.038-10 | 108591 | 10 | R 3/8 | 16 | 7 | 7,2 | 17,7 | 28,9 | 9,0 |
| 744.038-12 | 108592 | 12 | R 3/8 | 19 | 10 | 10,2 | 21,0 | 27,0 | 9,0 |
| 744.012-12 | 108593 | 12 | R 1/2 | 19 | 10 | 10,2 | 21,3 | 26,6 | 11,0 |

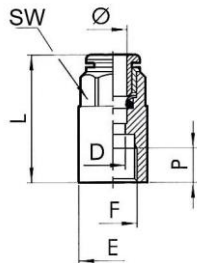

746.018-6

Gerade Steckverschraubungen, Innengewinde zylindrisch mit Außensechskant

| Typen Nr. | Artikel Nr. | Ø mm | F mm | SW mm | P mm | L mm | D mm | E mm |
|------------|-------------|------|-------|-------|------|------|------|------|
| 746.005-3 | 108571 | 3 | M5 | 7 | 4,5 | 15,7 | 2,5 | 7,8 |
| 746.018-4 | 108572 | 4 | G 1/8 | 10 | 7,0 | 26,2 | 3,0 | 14,0 |
| 746.018-5 | 108573 | 5 | G 1/8 | 12 | 7,0 | 27,5 | 4,0 | 14,0 |
| 746.018-6 | 108574 | 6 | G 1/8 | 12 | 7,0 | 27,1 | 5,0 | 14,0 |
| 746.018-8 | 108575 | 8 | G 1/8 | 13 | 7,0 | 28,1 | 7,0 | 14,0 |
| 746.014-4 | 108576 | 4 | G 1/4 | 10 | 8,0 | 28,6 | 3,0 | 17,0 |
| 746.014-5 | 108577 | 5 | G 1/4 | 12 | 8,0 | 29,5 | 4,0 | 17,0 |
| 746.014-6 | 108578 | 6 | G 1/4 | 12 | 8,0 | 29,3 | 5,0 | 17,0 |
| 746.014-8 | 108579 | 8 | G 1/4 | 14 | 8,0 | 30,0 | 7,0 | 17,0 |
| 746.014-10 | 108580 | 10 | G 1/4 | 16 | 8,0 | 31,8 | 8,0 | 17,7 |
| 746.038-10 | 108581 | 10 | G 3/8 | 16 | 10,0 | 36,8 | 8,0 | 20,8 |
| 746.038-12 | 108582 | 12 | G 3/8 | 19 | 10,0 | 37,0 | 10,0 | 20,8 |
| 746.012-12 | 108583 | 12 | G 1/2 | 19 | 11,0 | 40,5 | 10,0 | 23,8 |

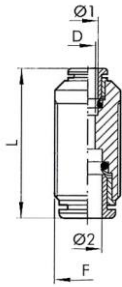

747.008

Gerade Steckverbindungen

| Typen Nr. | Artikel Nr. | Ø1 mm | Ø2 mm | F mm | L mm | D mm |
|-----------|-------------|----------|----------|---------|---------|---------|
| 747.003-3 | 108720 | 3 | 3 | M8x0,75 | 18,4 | 2,0 |
| 747.004 | 108721 | 4 | 4 | M11x1,0 | 30,6 | 2,5 |
| 747.0406 | 108728 | 4 | 6 | M13x1,0 | 32,7 | 2,5 |
| 747.005 | 108722 | 5 | 5 | M14x1,0 | 33,5 | 4,0 |
| 747.006 | 108723 | 6 | 6 | M13x1,0 | 33,0 | 4,5 |
| 747.0408 | 108729 | 4 | 8 | M15x1,0 | 34,4 | 2,5 |
| 747.0608 | 108730 | 6 | 8 | M15x1,0 | 35,0 | 4,5 |
| 747.008 | 108724 | 8 | 8 | M15x1,0 | 35,7 | 6,5 |
| 747.0610 | 108731 | 6 | 10 | M17x1,0 | 37,5 | 4,5 |
| 747.0612 | 108732 | 6 | 12 | M20x1,0 | 39,0 | 4,5 |
| 747.0810 | 108733 | 8 | 10 | M17x1,0 | 37,8 | 6,5 |
| 747.0812 | 108734 | 8 | 12 | M20x1,0 | 40,1 | 6,0 |
| 747.010 | 108725 | 10 | 10 | M17x1,0 | 39,2 | 8,0 |
| 747.012 | 108726 | 12 | 12 | M20x1,0 | 39,7 | 10,0 |
| 747.014 | 108727 | 14 | 14 | M24x1,0 | 45,9 | 12,0 |
| 747.1012 | 108735 | 10 | 12 | M20x1,0 | 40,8 | 8,0 |

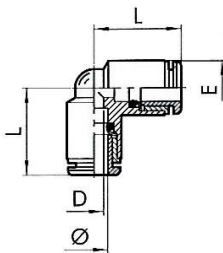

748.006

L-Steckverbindungen

| Typen Nr. | Artikel Nr. | Ø mm | L mm | D mm | E mm |
|-----------|-------------|---------|---------|---------|---------|
| 748.003 | 108752 | 3 | 10,4 | 2,0 | 6,3 |
| 748.004 | 108753 | 4 | 16,7 | 2,5 | 10,0 |
| 748.005 | 108754 | 5 | 19,2 | 3,0 | 13,5 |
| 748.006 | 108755 | 6 | 19,0 | 4,5 | 11,5 |
| 748.008 | 108756 | 8 | 21,3 | 6,5 | 13,5 |
| 748.010 | 108757 | 10 | 23,3 | 8,0 | 15,5 |
| 748.012 | 108758 | 12 | 26,0 | 10,0 | 20,5 |
| 748.014 | 108759 | 14 | 29,3 | 12,0 | 22,0 |

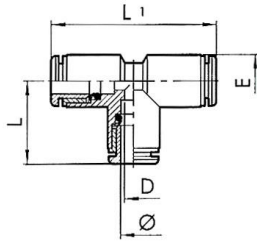

749.006

T-Steckverbindungen

| Typen Nr. | Artikel Nr. | Ø mm | L mm | L1 mm | D mm | E mm |
|-----------|-------------|------|------|-------|------|------|
| 749.003 | 108760 | 3 | 10,4 | 21,2 | 2,0 | 6,3 |
| 749.004 | 108761 | 4 | 16,7 | 33,4 | 2,5 | 10,0 |
| 749.005 | 108762 | 5 | 19,2 | 38,4 | 3,0 | 13,5 |
| 749.006 | 108763 | 6 | 19,0 | 38,0 | 4,5 | 11,5 |
| 749.008 | 108764 | 8 | 21,3 | 42,6 | 6,5 | 13,5 |
| 749.010 | 108765 | 10 | 23,3 | 46,6 | 8,0 | 15,5 |
| 749.012 | 108766 | 12 | 26,0 | 52,0 | 10,0 | 20,5 |
| 749.014 | 108767 | 14 | 29,3 | 58,6 | 12,0 | 22,0 |

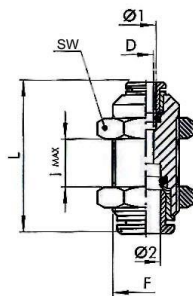

751.016-8

Gerade Schott-Steckverbindungen

| Typen Nr. | Artikel Nr. | Ø1 mm | Ø2 mm | F mm | SW mm | L mm | D mm | l max mm |
|--------------|-------------|-------|-------|---------|-------|------|------|----------|
| 751.008-3 | 108736 | 3 | 3 | M8x0,75 | 10 | 18,9 | 2,0 | 5,0 |
| 751.012-4 | 108737 | 4 | 4 | M11x1,0 | 13 | 30,6 | 2,5 | 11,0 |
| 751.013-46 | 108744 | 4 | 6 | M13x1,0 | 16 | 32,7 | 2,5 | 11,0 |
| 751.014-5 | 108738 | 5 | 5 | M14x1,0 | 17 | 33,5 | 4,0 | 8,0 |
| 751.014-6 | 108739 | 6 | 6 | M13x1,0 | 16 | 33,0 | 4,5 | 12,0 |
| 751.015-48 | 108745 | 4 | 8 | M15x1,0 | 17 | 34,4 | 2,5 | 12,0 |
| 751.015-68 | 108746 | 6 | 8 | M15x1,0 | 17 | 35,0 | 4,5 | 13,0 |
| 751.016-8 | 108740 | 8 | 8 | M15x1,0 | 17 | 35,7 | 6,5 | 13,5 |
| 751.017-610 | 108747 | 6 | 10 | M17x1,0 | 20 | 37,5 | 4,5 | 14,5 |
| 751.017-810 | 108748 | 8 | 10 | M17x1,0 | 20 | 37,8 | 6,5 | 15,0 |
| 751.020-10 | 108741 | 10 | 10 | M17x1,0 | 20 | 39,2 | 8,0 | 17,0 |
| 751.022-12 | 108742 | 12 | 12 | M20x1,0 | 24 | 40,7 | 10,0 | 20,3 |
| 751.020-612 | 108749 | 6 | 12 | M20x1,0 | 24 | 39,0 | 4,5 | 16,0 |
| 751.020-812 | 108750 | 8 | 12 | M20x1,0 | 24 | 40,1 | 6,0 | 18,5 |
| 751.020-1012 | 108751 | 10 | 12 | M20x1,0 | 24 | 40,8 | 8,0 | 19,0 |
| 751.024-14 | 108743 | 14 | 14 | M24x1,0 | 27 | 45,9 | 12,0 | 21,9 |

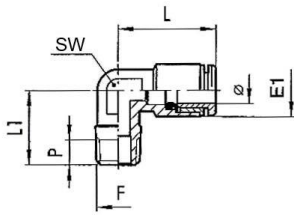

752.018-6

L-Steckverschraubungen, Außengewinde konisch

| Typen Nr. | Artikel Nr. | Ø mm | F mm | SW mm | E1 mm | L mm | L1 mm | P mm |
|------------|-------------|------|-------|-------|-------|------|-------|------|
| 752.018-4 | 108624 | 4 | R 1/8 | 10 | 9,5 | 18,6 | 16,0 | 6,2 |
| 752.018-6 | 108625 | 6 | R 1/8 | 10 | 11,8 | 21,9 | 16,0 | 6,2 |
| 752.018-8 | 108626 | 8 | R 1/8 | 10 | 13,5 | 25,4 | 16,0 | 6,2 |
| 752.014-6 | 108627 | 6 | R 1/4 | 10 | 11,8 | 21,9 | 18,5 | 8,5 |
| 752.014-8 | 108628 | 8 | R 1/4 | 10 | 13,5 | 25,4 | 18,5 | 8,5 |
| 752.014-10 | 108629 | 10 | R 1/4 | 14 | 16,0 | 27,2 | 22,0 | 8,5 |

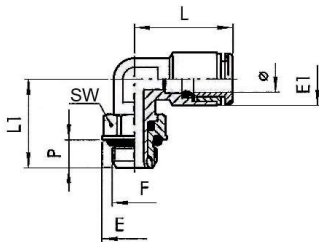

754.018-6

L-Steckverschraubungen, drehbar, Außengewinde zylindrisch mit O-ring

| Typen Nr. | Artikel Nr. | Ø mm | F mm | SW mm | E mm | E1 mm | L mm | L1 mm | P mm |
|------------|-------------|------|-------|-------|------|-------|------|-------|------|
| 754.005-4 | 108594 | 4 | M5 | 9 | 9,9 | 9,5 | 18,6 | 15,3 | 4,0 |
| 754.005-5 | 108595 | 5 | M5 | 9 | 9,9 | 11,5 | 22,8 | 15,3 | 4,0 |
| 754.005-6 | 108596 | 6 | M5 | 9 | 9,9 | 11,8 | 21,9 | 15,3 | 4,0 |
| 754.018-4 | 108597 | 4 | G 1/8 | 12 | 14,0 | 9,5 | 18,6 | 19,1 | 6,0 |
| 754.018-5 | 108598 | 5 | G 1/8 | 12 | 15,0 | 11,5 | 22,8 | 19,1 | 6,0 |
| 754.018-6 | 108599 | 6 | G 1/8 | 12 | 14,0 | 11,8 | 21,9 | 19,1 | 6,0 |
| 754.018-8 | 108600 | 8 | G 1/8 | 12 | 14,0 | 13,5 | 25,4 | 19,1 | 6,0 |
| 754.014-4 | 108601 | 4 | G 1/4 | 14 | 18,0 | 9,5 | 18,6 | 21,1 | 8,0 |
| 754.014-5 | 108602 | 5 | G 1/4 | 14 | 18,0 | 13,5 | 22,8 | 21,8 | 8,0 |
| 754.014-6 | 108603 | 6 | G 1/4 | 14 | 18,0 | 11,8 | 21,9 | 21,1 | 8,0 |
| 754.014-8 | 108604 | 8 | G 1/4 | 14 | 18,0 | 13,5 | 25,4 | 21,1 | 8,0 |
| 754.014-10 | 108605 | 10 | G 1/4 | 14 | 18,0 | 16,0 | 27,2 | 24,8 | 8,0 |
| 754.014-12 | 108606 | 12 | G 1/4 | 14 | 18,0 | 20,0 | 30,0 | 25,6 | 8,0 |
| 754.038-8 | 108607 | 8 | G 3/8 | 17 | 22,0 | 13,8 | 23,6 | 27,1 | 9,0 |
| 754.038-10 | 108608 | 10 | G 3/8 | 17 | 22,0 | 16,0 | 27,2 | 27,1 | 9,0 |
| 754.038-12 | 108609 | 12 | G 3/8 | 17 | 22,0 | 20,0 | 30,0 | 27,1 | 9,0 |
| 754.012-10 | 108610 | 10 | G 1/2 | 22 | 26,0 | 16,0 | 27,2 | 30,7 | 11,0 |
| 754.012-12 | 108611 | 12 | G 1/2 | 22 | 26,0 | 20,0 | 30,0 | 30,7 | 11,0 |
| 754.012-14 | 108612 | 14 | G 1/2 | 22 | 26,0 | 21,3 | 33,0 | 32,3 | 11,0 |

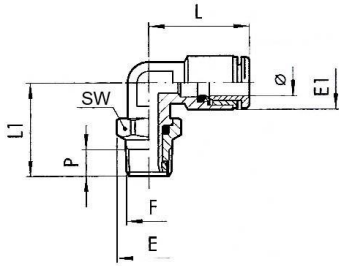

7754.018-6

L-Steckverschraubungen, drehbar, Außengewinde konisch

| Typen Nr. | Artikel Nr. | Ø mm | F mm | SW mm | E mm | E1 mm | L mm | L1 mm | P mm |
|-------------|-------------|------|-------|-------|------|-------|------|-------|------|
| 7754.018-4 | 108613 | 4 | R 1/8 | 12 | 13,3 | 9,5 | 18,6 | 19,8 | 6,2 |
| 7754.018-6 | 108614 | 6 | R 1/8 | 12 | 13,3 | 11,8 | 21,9 | 19,8 | 6,2 |
| 7754.018-8 | 108615 | 8 | R 1/8 | 12 | 13,3 | 13,5 | 25,4 | 19,8 | 6,2 |
| 7754.014-4 | 108616 | 4 | R 1/4 | 14 | 15,4 | 9,5 | 18,6 | 22,6 | 8,5 |
| 7754.014-6 | 108617 | 6 | R 1/4 | 14 | 15,4 | 11,8 | 21,9 | 22,6 | 8,5 |
| 7754.014-8 | 108618 | 8 | R 1/4 | 14 | 15,4 | 13,5 | 25,4 | 23,6 | 8,5 |
| 7754.014-10 | 108619 | 10 | R 1/4 | 14 | 15,4 | 16,0 | 27,2 | 26,3 | 8,5 |
| 7754.038-8 | 108620 | 8 | R 3/8 | 17 | 19,2 | 13,8 | 23,6 | 27,1 | 9,0 |
| 7754.038-10 | 108621 | 10 | R 3/8 | 17 | 19,2 | 16,0 | 27,2 | 27,1 | 9,0 |
| 7754.038-12 | 108622 | 12 | R 3/8 | 17 | 19,2 | 20,0 | 30,0 | 27,1 | 9,0 |
| 7754.012-12 | 108623 | 12 | R 1/2 | 22 | 24,6 | 20,0 | 30,0 | 31,9 | 11,0 |

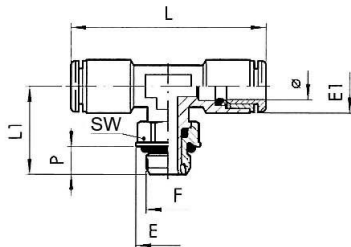

755.018-6

T-Steckverschraubungen, drehbar, Außengewinde zylindrisch mit O-Ring

| Typen Nr. | Artikel Nr. | Ø mm | F mm | SW mm | E mm | E1 mm | L mm | L1 mm | P mm |
|------------|-------------|------|-------|-------|------|-------|------|-------|------|
| 755.005-4 | 108649 | 4 | M5 | 9 | 8,0 | 9,5 | 37,2 | 15,3 | 4,0 |
| 755.005-6 | 108650 | 6 | M5 | 9 | 8,0 | 11,5 | 43,8 | 15,3 | 4,0 |
| 755.018-4 | 108651 | 4 | G 1/8 | 12 | 14,0 | 9,5 | 37,2 | 19,1 | 6,0 |
| 755.018-5 | 108652 | 5 | G 1/8 | 12 | 15,2 | 11,5 | 44,6 | 19,1 | 6,0 |
| 755.018-6 | 108653 | 6 | G 1/8 | 12 | 14,0 | 11,8 | 43,8 | 19,1 | 6,0 |
| 755.018-8 | 108654 | 8 | G 1/8 | 12 | 15,2 | 13,5 | 50,8 | 19,1 | 6,0 |
| 755.014-4 | 108655 | 4 | G 1/4 | 14 | 18,0 | 9,5 | 37,2 | 21,1 | 8,0 |
| 755.014-6 | 108656 | 6 | G 1/4 | 14 | 18,0 | 11,8 | 43,8 | 21,1 | 8,0 |
| 755.014-8 | 108657 | 8 | G 1/4 | 14 | 18,0 | 13,5 | 50,8 | 21,1 | 8,0 |
| 755.014-10 | 108658 | 10 | G 1/4 | 14 | 18,0 | 16,0 | 54,4 | 21,8 | 8,0 |
| 755.038-8 | 108659 | 8 | G 3/8 | 17 | 22,0 | 13,8 | 47,2 | 27,1 | 9,0 |
| 755.038-10 | 108660 | 10 | G 3/8 | 17 | 22,0 | 16,0 | 54,4 | 27,1 | 9,0 |
| 755.038-12 | 108661 | 12 | G 3/8 | 17 | 22,0 | 20,0 | 59,0 | 27,1 | 9,0 |
| 755.012-12 | 108662 | 12 | G 1/2 | 22 | 26,0 | 20,0 | 59,0 | 30,7 | 11,0 |
| 755.012-14 | 108663 | 14 | G 1/2 | 22 | 26,0 | 21,3 | 66,0 | 32,3 | 11,0 |

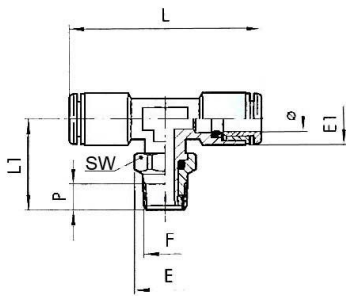

7755.018-6

T-Steckverschraubung, drehbar, Außengewinde konisch

| Typen Nr. | Artikel Nr. | Ø mm | F mm | SW mm | E mm | E1 mm | L mm | L1 mm | P mm |
|-------------|-------------|------|-------|-------|------|-------|------|-------|------|
| 7755.018-4 | 108664 | 4 | R 1/8 | 12 | 13,3 | 9,5 | 37,2 | 19,8 | 6,2 |
| 7755.018-6 | 108665 | 6 | R 1/8 | 12 | 13,3 | 11,8 | 43,8 | 19,8 | 6,2 |
| 7755.018-8 | 108666 | 8 | R 1/8 | 12 | 13,3 | 13,5 | 50,8 | 19,8 | 6,2 |
| 7755.014-4 | 108667 | 4 | R 1/4 | 14 | 15,4 | 9,5 | 37,2 | 22,6 | 8,5 |
| 7755.014-6 | 108668 | 6 | R 1/4 | 14 | 15,4 | 11,8 | 43,8 | 22,6 | 8,5 |
| 7755.014-8 | 108669 | 8 | R 1/4 | 14 | 15,4 | 13,5 | 50,8 | 23,6 | 8,5 |
| 7755.014-10 | 108670 | 10 | R 1/4 | 14 | 15,4 | 16,0 | 54,4 | 26,3 | 8,5 |
| 7755.038-8 | 108671 | 8 | R 3/8 | 17 | 19,2 | 13,8 | 47,2 | 27,1 | 9,0 |
| 7755.038-10 | 108672 | 10 | R 3/8 | 17 | 19,2 | 16,0 | 54,4 | 27,1 | 9,0 |

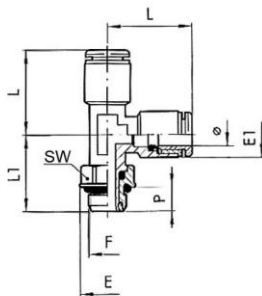

738.038-12

T-Steckverschraubungen, Steckanschlüsse in L-Form, drehbar, Außengewinde zylindrisch mit O-Ring

| Typen Nr. | Artikel Nr. | Ø mm | F mm | SW mm | E mm | E1 mm | L mm | L1 mm | P mm |
|------------|-------------|------|-------|-------|------|-------|------|-------|------|
| 738.018-4 | 108690 | 4 | G 1/8 | 12 | 14,0 | 9,5 | 18,6 | 19,1 | 6,0 |
| 738.018-6 | 108691 | 6 | G 1/8 | 12 | 14,0 | 11,5 | 21,9 | 19,1 | 6,0 |
| 738.018-8 | 108692 | 8 | G 1/8 | 12 | 14,0 | 13,5 | 25,4 | 19,1 | 6,0 |
| 738.014-6 | 108693 | 6 | G 1/4 | 14 | 18,0 | 11,5 | 21,9 | 21,1 | 8,0 |
| 738.014-8 | 108694 | 8 | G 1/4 | 14 | 18,0 | 13,5 | 25,4 | 22,1 | 8,0 |
| 738.014-10 | 108695 | 10 | G 1/4 | 14 | 18,0 | 16,0 | 27,2 | 21,8 | 8,0 |
| 738.038-10 | 108696 | 10 | G 3/8 | 17 | 22,0 | 16,0 | 27,2 | 27,1 | 9,0 |
| 738.038-12 | 108697 | 12 | G 3/8 | 17 | 22,0 | 20,0 | 30,0 | 27,1 | 9,0 |
| 738.012-12 | 108698 | 12 | G 1/2 | 22 | 26,0 | 20,0 | 30,0 | 30,7 | 11,0 |

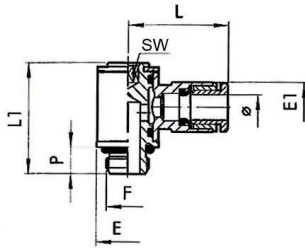

756.018-6

L-Steckverschraubungen mit Innensechskant, drehbar, Außengewinde zylindrisch mit O-Ring

| Typen Nr. | Artikel Nr. | Ø mm | F mm | SW mm | P mm | L mm | L1 mm | E mm | E1 mm |
|------------|-------------|------|-------|-------|------|------|-------|------|-------|
| 756.003-3 | 108630 | 3 | M3 | 1,5 | 3,0 | 12,2 | 13,2 | 5,8 | 5,8 |
| 756.005-3 | 108631 | 3 | M5 | 2 | 3,5 | 12,7 | 13,7 | 5,8 | 5,8 |
| 756.005-4 | 108632 | 4 | M5 | 2 | 4,0 | 20,2 | 18,4 | 9,5 | 9,5 |
| 756.005-5 | 108633 | 5 | M5 | 2 | 4,0 | 24,0 | 19,0 | 9,9 | 12,0 |
| 756.005-6 | 108634 | 6 | M5 | 2 | 4,0 | 23,5 | 18,4 | 9,5 | 11,3 |
| 756.007-4 | 108635 | 4 | M7 | 3 | 5,0 | 20,2 | 18,5 | 9,8 | 9,5 |
| 756.007-6 | 108636 | 6 | M7 | 3 | 5,0 | 23,5 | 18,5 | 9,8 | 11,3 |
| 756.018-4 | 108637 | 4 | G 1/8 | 3 | 6,0 | 21,3 | 24,9 | 14,0 | 9,5 |
| 756.018-5 | 108638 | 5 | G 1/8 | 3 | 6,0 | 24,8 | 26,2 | 14,0 | 12,0 |
| 756.018-6 | 108639 | 6 | G 1/8 | 3 | 6,0 | 23,0 | 24,9 | 14,0 | 11,5 |
| 756.018-8 | 108640 | 8 | G 1/8 | 3 | 6,0 | 24,8 | 24,9 | 14,0 | 13,8 |
| 756.014-6 | 108641 | 6 | G 1/4 | 4 | 8,0 | 24,5 | 29,4 | 18,0 | 11,5 |
| 756.014-8 | 108642 | 8 | G 1/4 | 4 | 8,0 | 26,5 | 29,4 | 18,0 | 13,8 |
| 756.014-10 | 108643 | 10 | G 1/4 | 4 | 8,0 | 31,4 | 29,4 | 18,0 | 16,5 |
| 756.014-12 | 108644 | 12 | G 1/4 | 4 | 8,0 | 33,0 | 29,4 | 18,0 | 19,5 |
| 756.038-8 | 108645 | 8 | G 3/8 | 5 | 9,0 | 28,5 | 35,6 | 22,0 | 13,8 |
| 756.038-10 | 108646 | 10 | G 3/8 | 5 | 9,0 | 32,8 | 35,6 | 22,0 | 15,5 |
| 756.038-12 | 108647 | 12 | G 3/8 | 5 | 9,0 | 35,3 | 35,6 | 22,0 | 19,5 |
| 756.012-12 | 108648 | 12 | G 1/2 | 8 | 11,0 | 37,0 | 40,8 | 26,0 | 19,5 |

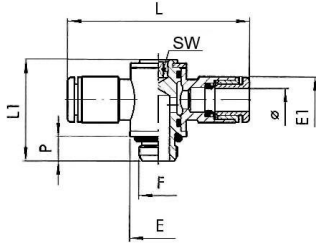

758.018-4 M

T-Steckverschraubungen mit Innensechskant, drehbar, Außengewinde zylindrisch mit O-Ring

| Typen Nr. | Artikel Nr. | Ø mm | F mm | SW mm | P mm | L mm | L1 mm | E mm | E1 mm |
|--------------|-------------|---------|---------|----------|---------|---------|----------|---------|----------|
| 758.005-4 M | 108673 | 4 | M5 | 2 | 4,0 | 40,4 | 18,4 | 9,5 | 9,5 |
| 758.005-5 M | 108674 | 5 | M5 | 2 | 4,0 | 47,6 | 18,8 | 9,9 | 12,0 |
| 758.005-6 M | 108675 | 6 | M5 | 2 | 4,0 | 47,0 | 18,4 | 9,5 | 11,3 |
| 758.007-4 M | 108676 | 4 | M7 | 3 | 5,0 | 40,4 | 18,5 | 9,8 | 9,5 |
| 758.007-6 M | 108677 | 6 | M7 | 3 | 5,0 | 47,0 | 18,5 | 9,8 | 11,3 |
| 758.018-4 M | 108678 | 4 | G 1/8 | 3 | 6,0 | 42,6 | 24,9 | 14,0 | 9,5 |
| 758.018-5 M | 108679 | 5 | G 1/8 | 3 | 6,0 | 49,5 | 27,0 | 14,0 | 13,5 |
| 758.018-6 M | 108680 | 6 | G 1/8 | 3 | 6,0 | 46,0 | 24,9 | 14,0 | 11,5 |
| 758.018-8 M | 108681 | 8 | G 1/8 | 3 | 6,0 | 49,6 | 24,9 | 14,0 | 13,8 |
| 758.014-6 M | 108682 | 6 | G 1/4 | 4 | 8,0 | 49,0 | 29,4 | 18,0 | 11,5 |
| 758.014-8 M | 108683 | 8 | G 1/4 | 4 | 8,0 | 53,0 | 29,4 | 18,0 | 13,8 |
| 758.014-10 M | 108684 | 10 | G 1/4 | 4 | 8,0 | 62,8 | 29,4 | 18,0 | 16,5 |
| 758.014-12 M | 108685 | 12 | G 1/4 | 4 | 8,0 | 66,0 | 29,4 | 18,0 | 19,5 |
| 758.038-8 M | 108686 | 8 | G 3/8 | 5 | 9,0 | 57,0 | 35,6 | 22,0 | 13,8 |
| 758.038-10 M | 108687 | 10 | G 3/8 | 5 | 9,0 | 65,6 | 35,6 | 22,0 | 15,5 |
| 758.038-12 M | 108688 | 12 | G 3/8 | 5 | 9,0 | 69,6 | 35,6 | 22,0 | 19,5 |
| 758.012-12 M | 108689 | 12 | G 1/2 | 8 | 11,0 | 73,0 | 40,8 | 26,0 | 19,5 |

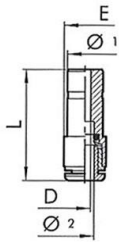

757.0604

Gerade Steckverbindungen mit Stecknippel, reduzierend

Nur für den Einsatz in Kombination mit Schnellsteckverbindungen der Serie »click-clock« empfohlen.
Die Eignungsprüfung für den Einsatz mit anderen Serien obliegt dem Anwender.

| Typen Nr. | Artikel Nr. | Ø 1 mm | Ø 2 mm | L mm | D mm | E mm |
|-----------|-------------|--------|--------|------|------|------|
| 757.0403 | 108771 | 4 | 3 | 26,0 | 2,0 | 6,3 |
| 757.0604 | 108772 | 6 | 4 | 29,9 | 2,8 | 9,5 |
| 757.0605 | 108773 | 6 | 5 | 36,0 | 4,0 | 12,0 |
| 757.0804 | 108774 | 8 | 4 | 28,7 | 2,8 | 9,5 |
| 757.0805 | 108775 | 8 | 5 | 34,5 | 4,0 | 12,0 |
| 757.0806 | 108776 | 8 | 6 | 31,9 | 4,5 | 11,5 |
| 757.1006 | 108777 | 10 | 6 | 36,2 | 5,0 | 11,5 |
| 757.1008 | 108778 | 10 | 8 | 40,8 | 7,0 | 14,0 |
| 757.1208 | 108779 | 12 | 8 | 40,1 | 7,0 | 15,5 |
| 757.1210 | 108780 | 12 | 10 | 44,3 | 8,2 | 16,0 |
| 757.1410 | 108781 | 14 | 10 | 44,3 | 8,2 | 16,0 |
| 757.1412 | 108782 | 14 | 12 | 50,0 | 10,0 | 19,5 |

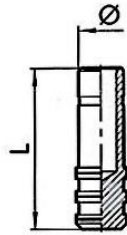

758.006

Verschlussstecker

Nur für den Einsatz in Kombination mit Schnellsteckverbindungen der Serie »click-clock« empfohlen.
Die Eignungsprüfung für den Einsatz mit anderen Serien obliegt dem Anwender.

| Typen Nr. | Artikel Nr. | Ø mm | L mm |
|-----------|-------------|------|------|
| 758.003 | 108790 | 3 | 20,0 |
| 758.004 | 108791 | 4 | 27,0 |
| 758.005 | 108792 | 5 | 27,0 |
| 758.006 | 108793 | 6 | 29,8 |
| 758.008 | 108794 | 8 | 33,6 |
| 758.010 | 108795 | 10 | 36,8 |
| 758.012 | 108796 | 12 | 39,0 |
| 758.014 | 108797 | 14 | 39,5 |

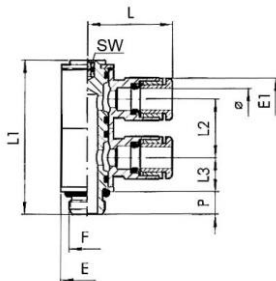

759.018-4 M

L-Mehrfachverteiler mit Innensechskant, 2-fach, drehbar, Außengewinde zylindrisch mit O-Ring

| Typen Nr. | Artikel Nr. | Ø mm | F mm | SW mm | E mm | E1 mm | L mm | L1 mm | L2 mm | L3 mm | P mm |
|--------------|-------------|------|-------|-------|------|-------|------|-------|-------|-------|------|
| 759.005-4 M | 108798 | 4 | M5 | 2 | 9,5 | 9,5 | 20,2 | 30,3 | 11,5 | 6,8 | 4,0 |
| 759.005-6 M | 108799 | 6 | M5 | 2 | 9,5 | 11,3 | 23,5 | 30,3 | 11,5 | 6,8 | 4,0 |
| 759.018-4 M | 108800 | 4 | G 1/8 | 3 | 14,0 | 9,0 | 20,2 | 40,9 | 15,5 | 9,1 | 6,0 |
| 759.018-5 M | 108801 | 5 | G 1/8 | 5 | 14,0 | 12,0 | 25,0 | 42,0 | 15,0 | 10,5 | 6,0 |
| 759.018-6 M | 108802 | 6 | G 1/8 | 3 | 14,0 | 11,3 | 23,5 | 40,9 | 15,5 | 9,1 | 6,0 |
| 759.018-8 M | 108803 | 8 | G 1/8 | 3 | 14,0 | 13,8 | 24,8 | 40,9 | 15,5 | 9,1 | 6,0 |
| 759.014-6 M | 108804 | 6 | G 1/4 | 4 | 18,0 | 11,5 | 23,0 | 47,0 | 17,2 | 10,2 | 8,0 |
| 759.014-8 M | 108805 | 8 | G 1/4 | 4 | 18,0 | 13,8 | 26,5 | 47,0 | 17,2 | 10,2 | 8,0 |
| 759.014-10 M | 108806 | 10 | G 1/4 | 4 | 18,0 | 16,5 | 31,4 | 47,0 | 17,2 | 10,2 | 8,0 |

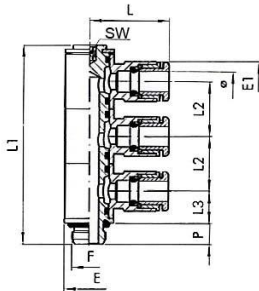

760.018-4 M

L-Mehrfachverteiler mit Innensechskant, 3-fach, drehbar, Außengewinde zylindrisch mit O-Ring

| Typen Nr. | Artikel Nr. | Ø mm | F mm | SW mm | E mm | E1 mm | L mm | L1 mm | L2 mm | L3 mm | P mm |
|--------------|-------------|------|-------|-------|------|-------|------|-------|-------|-------|------|
| 760.018-4 M | 108807 | 4 | G 1/8 | 3 | 14,0 | 9,5 | 20,2 | 56,7 | 15,5 | 9,1 | 6,0 |
| 760.018-6 M | 108808 | 6 | G 1/8 | 3 | 14,0 | 11,5 | 23,5 | 56,7 | 15,5 | 9,1 | 6,0 |
| 760.018-8 M | 108809 | 8 | G 1/8 | 3 | 14,0 | 13,8 | 24,8 | 56,7 | 15,5 | 9,1 | 6,0 |
| 760.014-6 M | 108810 | 6 | G 1/4 | 4 | 18,0 | 11,5 | 25,6 | 64,3 | 17,2 | 10,2 | 8,0 |
| 760.014-8 M | 108811 | 8 | G 1/4 | 4 | 18,0 | 13,8 | 26,5 | 64,3 | 17,2 | 10,2 | 8,0 |
| 760.014-10 M | 108812 | 10 | G 1/4 | 4 | 18,0 | 16,5 | 31,4 | 64,3 | 17,2 | 10,2 | 8,0 |

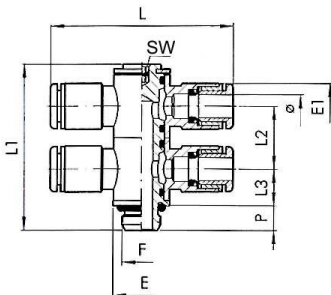

761.018-4 M

T-Mehrfachverteiler mit Innensechskant, 4-fach, drehbar, Außengewinde zylindrisch mit O-Ring

| Typen Nr. | Artikel Nr. | Ø mm | F mm | SW mm | E mm | E1 mm | L mm | L1 mm | L2 mm | L3 mm | P mm |
|--------------|-------------|------|-------|-------|------|-------|------|-------|-------|-------|------|
| 761.005-4 M | 108813 | 4 | M5 | 2 | 9,5 | 9,5 | 40,4 | 29,9 | 11,5 | 6,8 | 4,0 |
| 761.005-6 M | 108814 | 6 | M5 | 2 | 9,5 | 11,3 | 47,0 | 29,9 | 11,5 | 6,8 | 4,0 |
| 761.018-4 M | 108815 | 4 | G 1/8 | 3 | 14,0 | 9,5 | 40,4 | 40,9 | 15,5 | 9,1 | 6,0 |
| 761.018-6 M | 108816 | 6 | G 1/8 | 3 | 14,0 | 11,3 | 46,0 | 41,1 | 15,5 | 9,1 | 6,0 |
| 761.018-8 M | 108817 | 8 | G 1/8 | 3 | 14,0 | 13,8 | 49,6 | 41,1 | 15,5 | 9,1 | 6,0 |
| 761.014-6 M | 108818 | 6 | G 1/4 | 4 | 18,0 | 11,3 | 49,0 | 47,0 | 17,2 | 10,2 | 8,0 |
| 761.014-8 M | 108818 | 8 | G 1/4 | 4 | 18,0 | 13,8 | 53,0 | 47,0 | 17,2 | 10,2 | 8,0 |
| 761.014-10 M | 108819 | 10 | G 1/4 | 4 | 18,0 | 16,5 | 62,8 | 47,0 | 17,2 | 10,2 | 8,0 |

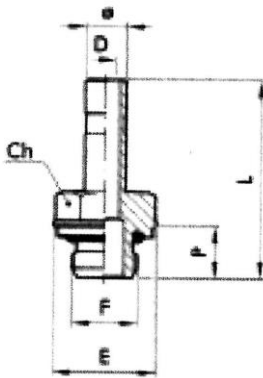

768.014-6

Gewinde-Stecknippel, Außengewinde zylindrisch mit O-Ring

Durch Kombination mit geraden Steckverbindungen, L- und T-Verbindungen können die wichtigsten Anschlussvarianten erstellt und gleichzeitig die Lagerhaltungskosten gesenkt werden.

Nur für den Einsatz in Kombination mit Schnellsteckverbindungen der Serie »click-clock« empfohlen. Die Eignungsprüfung für den Einsatz mit anderen Serien obliegt dem Anwender.

| Typen Nr. | Artikel Nr. | Ø mm | F mm | SW mm | P mm | L mm | D mm | E mm |
|------------|-------------|------|-------|-------|------|------|------|------|
| 768.005-3 | 108699 | 3 | M5 | 5 | 3,5 | 16,8 | 2,0 | 5,8 |
| 768.005-4 | 108700 | 4 | M5 | 8 | 4,0 | 25,2 | 2,5 | 9,0 |
| 768.005-5 | 108701 | 5 | M5 | 8 | 4,0 | 25,2 | 2,3 | 9,0 |
| 768.005-6 | 108702 | 6 | M5 | 9 | 4,0 | 25,7 | 2,7 | 10,0 |
| 768.018-4 | 108703 | 4 | G 1/8 | 13 | 6,0 | 28,9 | 2,5 | 14,8 |
| 768.018-5 | 108704 | 5 | G 1/8 | 13 | 6,0 | 28,9 | 3,0 | 14,8 |
| 768.018-6 | 108705 | 6 | G 1/8 | 13 | 6,0 | 29,4 | 4,0 | 14,8 |
| 768.018-8 | 108706 | 8 | G 1/8 | 13 | 6,0 | 30,6 | 5,5 | 14,8 |
| 768.014-4 | 108707 | 4 | G 1/4 | 14 | 8,0 | 32,4 | 2,2 | 17,7 |
| 768.014-5 | 108708 | 5 | G 1/4 | 14 | 8,0 | 32,4 | 3,0 | 17,7 |
| 768.014-6 | 108709 | 6 | G 1/4 | 14 | 8,0 | 32,9 | 4,0 | 17,7 |
| 768.014-8 | 108710 | 8 | G 1/4 | 14 | 8,0 | 34,0 | 6,0 | 17,7 |
| 768.014-10 | 108711 | 10 | G 1/4 | 14 | 8,0 | 37,2 | 7,8 | 17,7 |
| 768.014-12 | 108712 | 12 | G 1/4 | 14 | 8,0 | 40,7 | 7,8 | 17,7 |
| 768.038-8 | 108713 | 8 | G 3/8 | 17 | 9,0 | 35,4 | 6,0 | 21,7 |
| 768.038-10 | 108714 | 10 | G 3/8 | 17 | 9,0 | 37,1 | 8,0 | 21,7 |
| 768.038-12 | 108715 | 12 | G 3/8 | 17 | 9,0 | 42,2 | 10,0 | 21,7 |
| 768.038-14 | 108716 | 14 | G 3/8 | 17 | 9,0 | 46,2 | 10,0 | 21,7 |
| 768.012-10 | 108717 | 10 | G 1/2 | 19 | 11,0 | 41,0 | 8,0 | 25,7 |
| 768.012-12 | 108718 | 12 | G 1/2 | 22 | 11,0 | 44,2 | 10,0 | 25,7 |
| 768.012-14 | 108719 | 14 | G 1/2 | 22 | 11,0 | 48,2 | 12,0 | 25,7 |

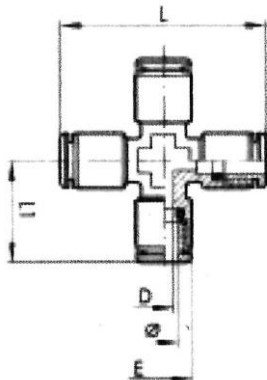

767.006

X-Steckverbindungen

| Typen Nr. | Artikel Nr. | Ø mm | D mm | E mm | L mm | L1 mm |
|-----------|-------------|---------|---------|---------|---------|----------|
| 767.004 | 108768 | 4 | 3,0 | 9,5 | 37,2 | 18,6 |
| 767.006 | 108769 | 6 | 4,5 | 11,5 | 43,8 | 21,9 |
| 767.008 | 108770 | 8 | 6,5 | 14,0 | 50,8 | 25,4 |

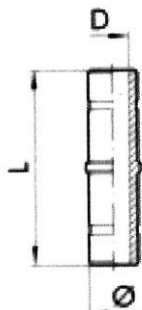

769.006

Stecknippel

Nur für den Einsatz in Kombination mit Schnellsteckverbindungen der Serie »click-clock« empfohlen.
Die Eignungsprüfung für den Einsatz mit anderen Serien obliegt dem Anwender.

| Typen Nr. | Artikel Nr. | Ø mm | L mm | D mm |
|-----------|-------------|---------|---------|---------|
| 769.004 | 108783 | 4 | 34,0 | 2,0 |
| 769.005 | 108784 | 5 | 34,0 | 3,0 |
| 769.006 | 108785 | 6 | 37,5 | 4,0 |
| 769.008 | 108786 | 8 | 37,5 | 6,0 |
| 769.010 | 108787 | 10 | 45,0 | 8,0 |
| 769.012 | 108788 | 12 | 48,0 | 10,0 |
| 769.014 | 108789 | 14 | 58,0 | 12,0 |

Sortimentsbox Schnellsteckverbindungen

Serie »click-clock«

Handliche, robuste und qualitativ hochwertige Kunststoff- Sortimentsbox mit den gängigsten Teilen unserer Schnellsteckverbinder aus Messing vernickelt, Serie »click-clock «

Insgesamt 30 verschiedene Sorten von Kleinteilen sind in 24 Kunststoffboxen übersichtlich präsentiert. Die Einsätze können herausgenommen und in der Box selbst individuell platziert werden. Alle Einsätze sind mit den Artikelnummern der beinhalteten Teile beschriftet.

Bestückung: 45 gerade Steckverschraubungen G 1/8-6 • G 1/4-4 • G 1/4-6 • G 1/4-8 • G 3/8-8
35 L-Steckverschraubungen G 1/8-4 • G 1/8-6 • G 1/4-6 • G 1/4-8 • G 3/8-8
15 gerade Steckverbindungen 4, 6, 8 mm
10 L-Steckverbindungen 6, 8 mm
15 T-Verbinder 4, 6, 8 mm
15 drehbare T-Steckverschraubungen G 1/8-6 • G 1/4-6 • G 1/4-8
9 gerade Steckverbindungen mit Stecknippel, reduzierend 8/6 • 10/6 • 10/8
10 Verschlussstecker 6, 8 mm
10 Muffen G 1/8 • G 1/4 • G 3/8
1 PTFE-Dichtband
1 Schlauchabschneider

| Typen Nr. | Artikel Nr. |
|-----------|-------------|
| PIB 200 | 108821 |



PIB 200